

# Parts Manual

Mfg. No: 1696092  
Dozer Blade, 42"



---

<b>Model Components</b>	<b>Page</b>
42" Snow Blade (1696092).....	4
Torque Specification Chart.....	8

Not For  
Reproduction

# 42" Snow Blade (1696092)

Note: Unless noted otherwise, use the standard torque specifications

Mfg. No: 1696092

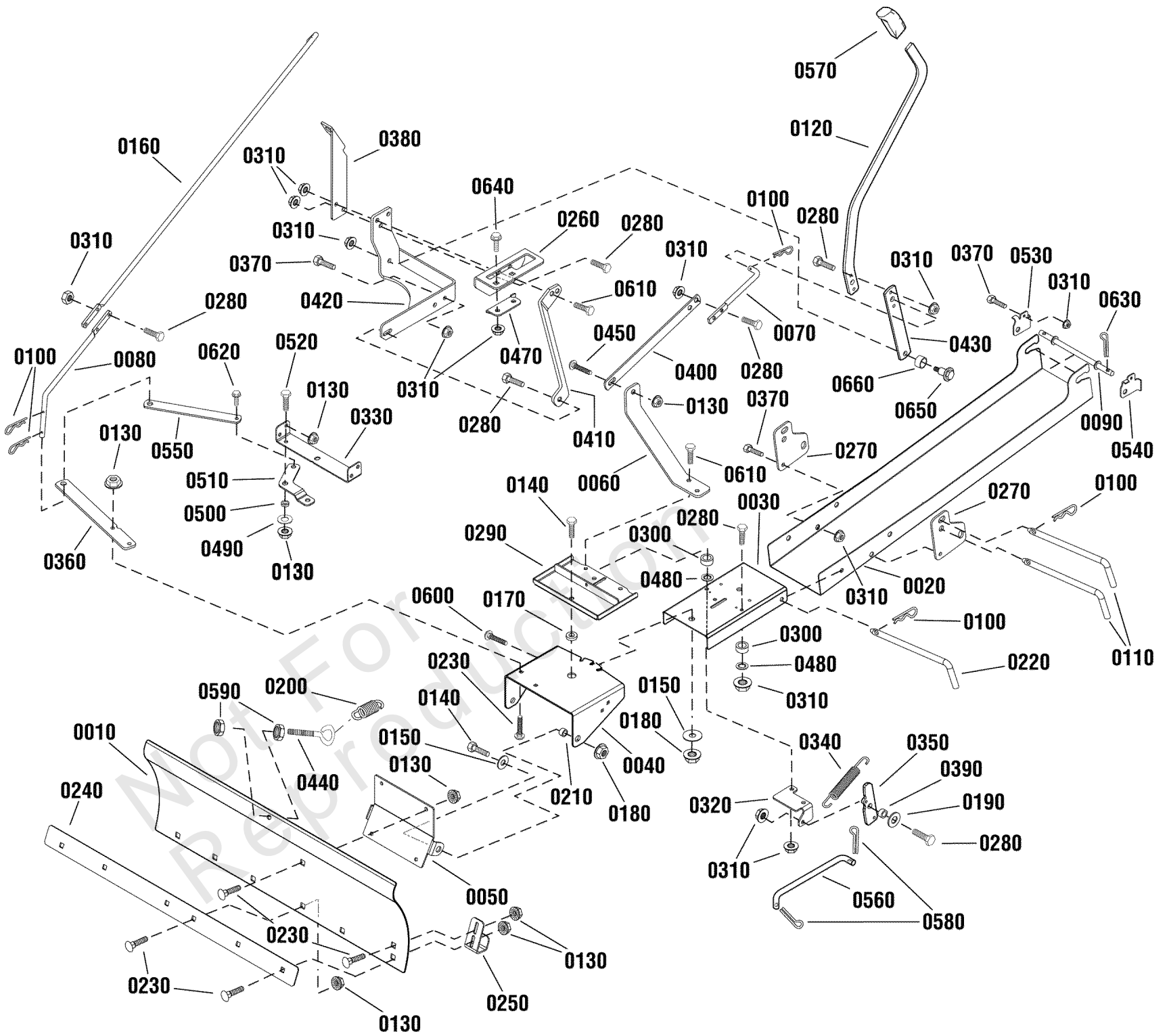

## 42" Snow Blade (1696092)

REF NO	PART NO	QTY	DESCRIPTION
0010	1730075A	1	BLADE, 42
0020	1752376A	1	SUBFRAME
0030	1730077A	1	HITCH, Lift
0040	1730078A	1	HITCH, Pivot
0050	1730079A	1	PLATE, Backer
0060	1752421A	1	SUPPORT, Blade Lift
0070	1752607	1	ROD, Lift
0080	1752418	1	ROD, Angle Lift
0090	1752371	1	ROD, Rear Support
0100	1918196	8	PIN, Spring .091 X 1.88
0110	1731414	2	ROD, Latch, 1/2 Dia. X 9 Lg (42" Mower)
0120	1752360A	1	ARM, Lift
0130	1931211	20	NUT, Hex Flange Whiz Lock, 3/8-16, Small
0140	1921176	3	CAPSCREW, Hex Head, 1/2-13 x 1-11/32, G5
0150	1918431	3	WASHER, Plain, 1/2 x 1-3/8 OD
0160	1753678	1	ROD, Blade Angle
0170	1719683	1	SPACER, 9/16 x 1
0180	1960668	3	* NUT, Hex Flange 1/2-13
0190	1919381	2	WASHER-0.312(0.34IDX1.00ODX.13THK)BLK
0200	2101126	1	SPRING, Extension
0210	1709235	1	SPACER, .52 x 3/4
0220	1715758	2	ROD, Latch
0230	1931350	1	BOLT, RD HD SH SQ NK 3/8- 16X1.000 G5 BL
0240	1731351A	12	BAR, Scraper
0250	1731352A	1	SHOE, Skid
0260	1752362A	2	QUADRANT, Lift
0270	1752417A	1	SUBFRAME, Front Mounting
0280	1921333	2	BOLT, 5/16-18 x 1
0290	1732454A	10	BRACKET ASSEMBLY, Hold Down
0300	1666697	1	SPACER-0.328ID 0.497OD 0.218LG PM YEL
0310	1960686	3	NUT, Hex Flange, ESNA, 5/16-18
0320	1731360A	23	BRACKET, Latch Pivot
0330	1732594A	1	BRACKET, Cross Brace
0340	2156302	1	SPRING
0350	1732756A	1	BAR, Latch
0360	1752419A	1	PLATE, Blade Mounting
0370	1921332	1	BOLT, 5/16-18 x 3/4
0380	1752662A	7	SUPPORT, Blade Angling
0390	1703900	1	SPACER, .323 I.D. x .500 O.D. x 0.270 Long Heat Treated
0400	1752610A	1	BAR, Lift
0410	1752609A	1	BRACE, Lift Support
0420	1752448A	1	SUPPORT ASSEMBLY, Lift
0430	1752412A	1	ARM, Blade Lift
0440	1675198	1	EYE BOLT, 5/16"18 x 18
0450	7014981	1	BOLT, Hex Flange, 3/8-24 GR 8
0470	1752801A	1	WEAR BRACKET
0480	1933988	3	NUT, Push, 5/16
0490	1924356	1	WASHER, Plain, 13/32 x 1-1/2 x 1/8
0500	1663752	1	SPACER, 25/64 x 5/8 x 3/16, Hardened
0510	1732147A	1	LEVER, Latch
0520	1921966	1	CAPSCREW, Hex Head, 3/8-16 x 7/8

# 42" Snow Blade (1696092)

Note: Unless noted otherwise, use the standard torque specifications

Mfg. No: 1696092

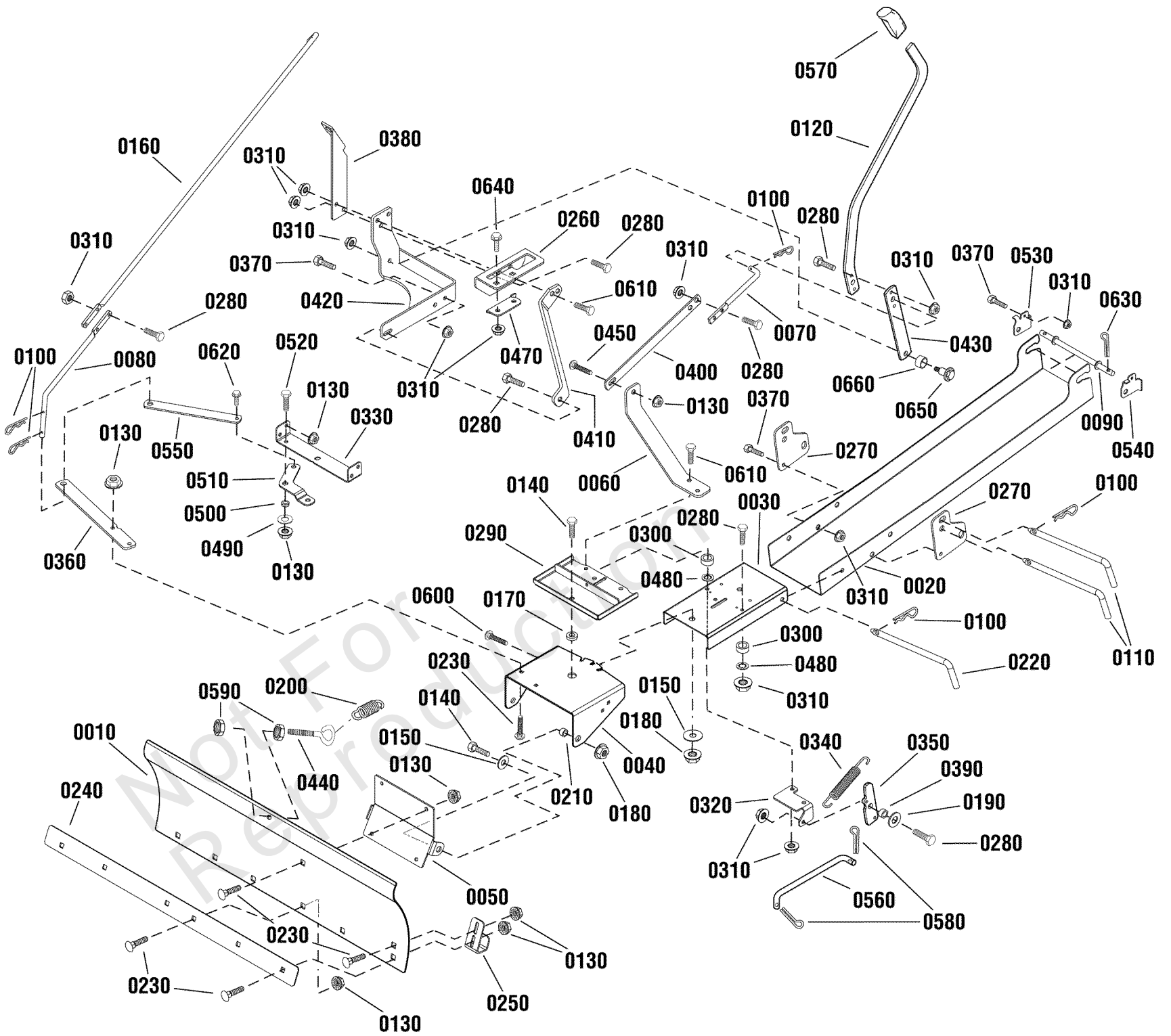

## 42" Snow Blade (1696092)

REF NO	PART NO	QTY	DESCRIPTION
0530	1752369A	1	HITCH BRACKET, Rear RH
0540	1752370A	1	HITCH BRACKET, Rear LH
0550	1752497A	1	BAR, Shift
0560	1732355	1	LINK
0570	1722302	1	GRIP
0580	1918447	2	PIN, Cotter, 3/4, Black
0590	1917372	2	NUT, Hex, 5/16-18
0600	1931348	4	BOLT, Carriage 3/18"18 x 5/8
0610	1921977	3	SCREW, 5/16-18 x 1-1/4" Hex Head Cap, GR5, Black
0620	1732426	1	BOLT, Shoulder, 5/16-18 x .13/16, 1/2" Thread Length
0630	1918452	2	PIN, Cotter 1/8 X 1
0640	1931332	2	BOLT, Round Head, Short Neck, 5/16-18 x 5/8
0650	1732412	1	SHOULDER BOLT, 5/16"18
0660	----	1	SPRING, Compression

Not For Reproduction

# Hardware Identification & Torque Specifications

Torque Specification Chart								
FOR STANDARD METRIC MACHINE HARDWARE (Tolerance ± 20%)								
Property Class	5.6		8.8		10.9		12.9	
	Class 5.6		Class 8.8		Class 10.9		Class 12.9	
Size Of Hardware	in/lbs	Nm.	in/lbs	Nm.	in/lbs	Nm.	in/lbs	Nm.
	ft/lbs		ft/lbs		ft/lbs		ft/lbs	
M3	5.88	.56	13.44	1.28	19.2	1.80	22.92	2.15
M4	13.44	1.28	30.72	2.90	43.44	4.10	52.56	4.95
M5	26.4	2.50	60.96	5.75	5.97	8.10	7.15	9.7
M6	44.64	4.3	7.3	9.9	10.3	14	12.1	16.5
M7	5.2	7.1	12.1	16.5	16.9	23	19.9	27
M8	7.7	10.5	17.7	24	25	34	29	40
M10	15	21	35	48	50	67	59	81
M12	26	36	61	83	86.2	117	103	140
M14	42	58	101	132	136	185	162	220
M16	64	88	147	200	210	285	250	340
M18	89	121	202	275	287	390	346	470
M20	126	171	290	390	405	550	486	660
M22	169	230	390	530	559	745	656	890
M24	217	295	497	375	708	960	840	1140
M27	320	435	733	995	1032	1400	1239	1680
M30	435	590	995	1350	1401	1900	1681	2280
M33	590	800	1349	1830	1902	2580	2278	3090
M36	759	1030	1740	2360	2441	3310	2935	3980
M39	988	1340	2249	3050	3163	4290	3798	5150

Torque Specification Chart						
FOR STANDARD MACHINE HARDWARE (Tolerance ± 20%)						
Hardware Grade	No Marks		SAE Grade 5		SAE Grade 8	
	SAE Grade 2		SAE Grade 5		SAE Grade 8	
Size Of Hardware	in/lbs	Nm.	in/lbs	Nm.	in/lbs	Nm.
	ft/lbs		ft/lbs		ft/lbs	
8-32	19	2.1	30	3.4	41	4.6
8-36	20	2.3	31	3.5	43	4.9
10-24	27	3.1	43	4.9	60	6.8
10-32	31	3.5	49	5.5	68	7.7
1/4-20	66	7.6	8	10.9	12	16.3
1/4-28	76	8.6	10	13.6	14	19.0
5/16-18	11	15.0	17	23.1	25	34.0
5/16-24	12	16.3	19	25.8	29	34.0
3/8-16	20	27.2	30	40.8	45	61.2
3/8-24	23	31.3	35	47.6	50	68.0
7/16-14	30	40.8	50	68.0	70	95.2
7/16-20	35	47.6	55	74.8	80	108.8
1/2-13	50	68.0	75	102.0	110	149.6
1/2-20	55	74.8	90	122.4	120	163.2
9/16-12	65	88.4	110	149.6	150	204.0
9/16-18	75	102.0	120	163.2	170	231.2
5/8-11	90	122.4	150	204.0	220	299.2
5/8-18	100	136	180	244.8	240	326.4
3/4-10	160	217.6	260	353.6	386	525.0
3/4-16	180	244.8	300	408.0	420	571.2
7/8-9	140	190.4	400	544.0	600	816.0
7/8-14	155	210.8	440	598.4	660	897.6
1-8	220	299.2	580	788.8	900	1,244.0
1-12	240	326.4	640	870.4	1,000	1,360.0

The guides and ruler furnished below are designed to help you select the appropriate hardware.

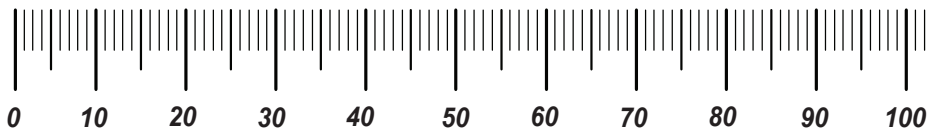

Nut, M8

Thread Diameter (mm)

Inside Diameter (in)      Threads per inch

Nut, 1/2-16

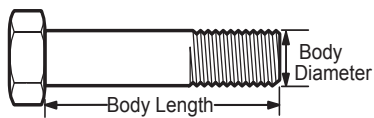

Screw, M8- 1.25 x 25

Thread Diameter (mm)      Distance between threads (mm)      Body Length (mm)

Body Diameter      Threads per inch      Body Length (in)

Screw, 1/2- 16 x 2

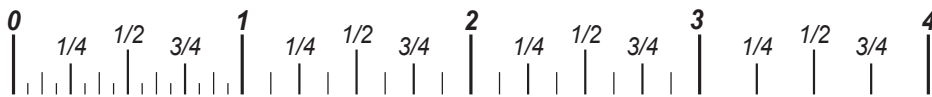

## Standard Hardware Sizing

When a washer or nut is identified as 1/2" (M8), this is the *Nominal size*, meaning the *inside diameter* is 1/2 inch (8mm metric thread diameter); if a second number is present it represents the *threads per inch* (distance between threads).

When bolt or capscrew is identified as 1/2 - 16 x 2" (M8 - 1.25 x 50), this means the *Nominal size*, or body diameter is 1/2 inch (8mm metric thread diameter), the second number, 16, represents the *threads per inch*, (*distance between threads*). The final number is the body length of the bolt or screw, 2 inches (50mm).

## NOTES

- These torque values are to be used for all hardware excluding: locknuts, self-tapping screws, thread forming screws, sheet metal screws and socket head setscrews.
- Recommended seating torque values for locknuts:
  - for prevailing torque locknuts - use 65% of grade 5 torques.
  - for flange whizlock nuts and screws - use 135% of grade 5 torques.
- Unless otherwise noted on assembly drawings, all torque values must meet this specification.

## Common Hardware Types

Hex Head Capscrew



Washer



Carriage Bolt



Hex Nut

## Wrench & Fastener Size Guide

1/4" Bolt or Nut Wrench—7/16"	5/16" Bolt or Nut Wrench—1/2"	3/8" Bolt or Nut Wrench—9/16"	7/16" Bolt or Nut Wrench (Bolt)—5/8" Wrench (Nut)—11/16"	1/2" Bolt or Nut Wrench—3/4"
M6 Bolt or Nut Wrench—10mm	M8 Bolt or Nut Wrench—13mm	M10 Bolt or Nut Wrench—17mm	M12 Bolt or Nut Wrench—19mm	M14 Bolt or Nut Wrench—22mm



